

Technical data

Wolf Cell

Pressure-resistant height adjustment

- very high compressive strength
- easy processing
- ecological material
- easy disposal
- suitable for large tile formats

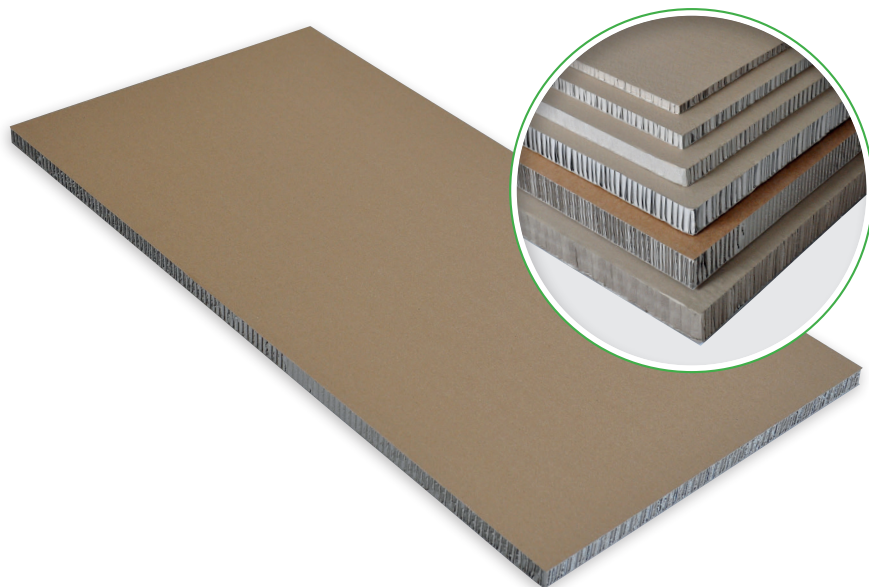

Product description

Wolf Cell is the ecological and pressure-resistant height leveller for floor constructions.

Dimensions	Length x width ± 0.11 [in]	Thickness ± 0.04 [in]	Weight [lb/yd²]	Suitable for Point loads [klb]*	Surface load [klb /yd²]*	Thermal conductivity [BTU·in/h·ft²·°F]
Wolf Cell 20	47.2 x 31.5	0.79	3.21	0.9	1.34	0.694
Wolf Cell 30		1.18	3.68			
Wolf Cell 40		1.57	4.52			
Wolf Cell 60		2.36	6.11			
Wolf Cell 80		3.15	9.93			

*in conjunction with Wolf Hugo N & F.

Storage:

- Only store Wolf Cell panels indoors, horizontally, flat, dry and frost-free
- Store at the installation site for 24 hours to acclimatise
- Protect edges from damage.